

DIN 912 HEXAGON SOCKET HEAD CAP SCREWS

ISO 4762

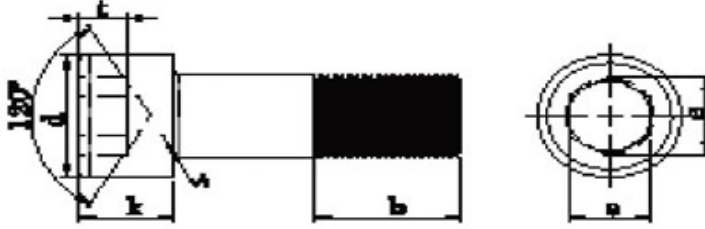

Teknik Bilgiler / Technical Informations		M3	M4	M5	M6	M8	M10	M12	M14
Thread size / Anma çapı (d)		M3	M4	M5	M6	M8	M10	M12	M14
Pitch / Diş adımı	P	0,50	0,70	0,80	1,00	1,25	1,50	1,75	2,00
Head height / Kafa yüksekliği	k max.	3,00	4,00	5,00	6,00	8,00	10,00	12,00	14,00
	k min.	2,86	3,82	4,82	5,70	7,64	9,64	11,57	13,57
Head Dia / Kafa çapı	d max.	5,50	7,00	8,50	10,00	13,00	16,00	18,00	21,00
	d min.	5,32	6,78	8,28	9,78	12,73	15,73	17,73	20,67
Socket width / Soket genişliği	s min.	2,50	3,00	4,00	5,00	6,00	8,00	10,00	12,00
	s max.	2,52	3,02	4,02	5,02	6,02	8,03	10,03	12,03
Socket dia / Soket çapı	e	2,87	3,44	4,58	5,72	6,86	9,15	11,43	13,72
Socket depth / Soket derinliği	t	1,30	2,00	2,50	3,00	4,00	5,00	6,00	7,00
Thread length / Diş uzunluğu	b ¹	18,00	20,00	22,00	24,00	28,00	32,00	36,00	40,00
	b ²	Fully threaded. / Tam dişli.							

b¹ for lengths l ≤ 125 mm.

b² for lengths l 125 mm. ≤ 200 mm.

b³ for lengths > 200 mm.

Thread size / Anma çapı (d)		M3	M4	M5	M6	M8	M10	M12	M14
Length Boy	min.	Weight /Ağırlık gr/p							
	max.								
5	4,76	5,24	0,67						
6	5,76	6,24	0,71	1,50					
8	7,71	8,29	0,80	1,65	2,45				
10	9,71	10,29	0,88	1,80	2,70	4,70			
12	11,65	12,35	0,96	1,95	2,95	5,07	10,90		
16	15,65	16,35	1,16	2,25	3,45	5,75	12,10	20,90	
20	19,58	20,42	1,36	2,65	4,01	6,53	13,40	22,90	32,10
25	24,58	25,42	1,61	3,15	4,78	7,59	15,00	25,40	35,70
30	29,58	30,42	1,86	3,65	5,55	8,30	16,90	27,90	39,30
35	34,50	35,50		4,15	6,32	9,91	18,90	30,40	42,90
40	39,50	40,50		4,65	7,09	11,00	20,90	32,90	46,50
45	44,50	45,50		5,15	7,86	12,10	22,90	36,10	50,10
50	49,50	50,50		5,65	8,63	13,20	24,90	39,30	54,50
55	54,40	55,60			9,40	14,30	26,90	42,50	58,90
60	59,40	60,60			10,20	15,40	28,90	45,70	63,40
65	64,40	65,60			11,00	16,40	31,00	48,90	67,80
70	69,40	70,60			11,80	17,30	33,00	52,10	71,30
80	79,40	80,60			13,25	19,30	37,00	58,50	80,20

DIN 912 HEXAGON SOCKET HEAD CAP SCREWS

ISO 4762

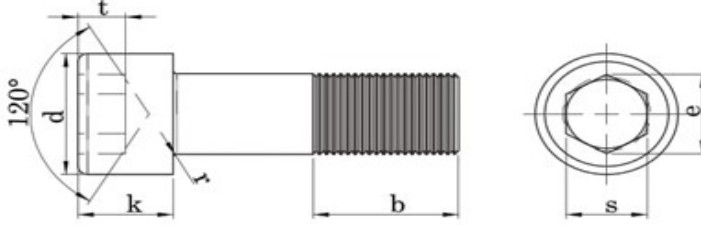

Teknik Bilgiler / Technical Informations			M3	M4	M5	M6	M8	M10	M12	M14
Thread size / Anma çapı (d)			M3	M4	M5	M6	M8	M10	M12	M14
Pitch / Diş adımı	P		0,50	0,70	0,80	1,00	1,25	1,50	1,75	2,00
Head height / Kafa yüksekliği	k	max.	3,00	4,00	5,00	6,00	8,00	10,00	12,00	14,00
		min.	2,86	3,82	4,82	5,70	7,64	9,64	11,57	13,57
Head Dia / Kafa çapı	d	max.	5,50	7,00	8,50	10,00	13,00	16,00	18,00	21,00
		min.	5,32	6,78	8,28	9,78	12,73	15,73	17,73	20,67
Socket width / Soket genişliği	s	min.	2,50	3,00	4,00	5,00	6,00	8,00	10,00	12,00
		max.	2,52	3,02	4,02	5,02	6,02	8,03	10,03	12,03
Socket dia / Soket çapı	e		2,87	3,44	4,58	5,72	6,86	9,15	11,43	13,72
Socket depth / Soket derinliği	t		1,30	2,00	2,50	3,00	4,00	5,00	6,00	7,00
Thread length / Diş uzunluğu	b ¹ b ²		18,00	20,00	22,00	24,00	28,00	32,00	36,00	40,00
			Fully threaded. /Tam dişli.							

b¹ for lengths l ≤ 125 mm.

b² for lengths l 125 mm. ≤ 200 mm.

b³ for lengths > 200 mm.

Thread size / Anma çapı (d)		M3	M4	M5	M6	M8	M10	M12	M14
Length Boy	min.	Weight /Ağırlık gr/p							
	max.								
90	89,30			14,79	21,30	41,00	64,90	89,10	120,00
100	99,30			16,33	23,30	45,00	71,20	98,00	132,00
110	109,30			19,40	25,30	49,00	77,50	107,00	144,00
120	119,30				27,30	53,00	83,80	116,00	156,00
130	129,20				31,00	57,00	90,10	126,97	168,00
140	139,20				33,00	61,00	96,40	135,50	180,00
150	149,20					65,00	102,70	145,00	192,00
160	159,20					69,00	108,00	154,00	204,00
180	179,20								
200	199,10								
220	219,10								
240	239,10								
260	258,95								
280	278,95								
300	298,95								

Socket Cap Screw to DIN 912 standard are often referred to as Allen head bolts. They host a hexagonal recess and are driven using an insert bit or a hex wrench, making the screws more efficient than the slotted screw products. This is due to the hex socket drive having more resistance to cam out.

DIN 912 HEXAGON SOCKET HEAD CAP SCREWS

ISO 4762

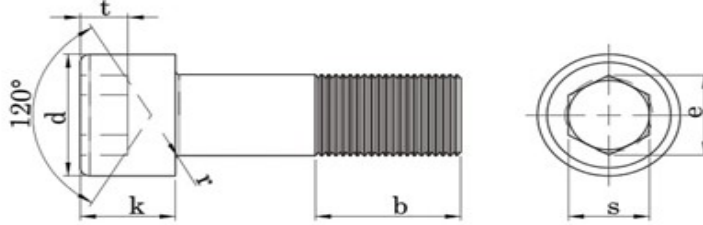

Teknik Bilgiler / Technical Informations		M16	M18	M20	M22	M24	M27	M30	M33	
Thread size / Anma çapı (d)		M16	M18	M20	M22	M24	M27	M30	M33	
Pitch / Diş adımı	P	2,00	2,50	2,50	2,50	3,00	3,00	3,50	3,50	
Head height / Kafa yüksekliği	k	max.	16,00	18,00	20,00	22,00	24,00	27,00	30,00	33,00
		min.	15,57	17,57	19,48	21,48	23,48	26,48	29,48	32,38
Head Dia / Kafa çapı	d	max.	24,00	27,00	30,00	33,00	36,00	40,00	45,00	50,00
		min.	23,67	26,67	29,67	32,61	35,61	39,61	44,61	49,61
Socket width / Soket genişliği	s	min.	14,00	14,00	17,00	17,00	19,00	19,00	22,00	24,00
		max.	14,03	14,03	17,05	17,05	19,07	19,07	22,07	24,07
Socket dia / Soket çapı	e	16,00	16,00	19,44	19,44	21,73	21,73	25,15	27,43	
Socket depth / Soket derinliği	t	8,00	9,00	10,00	11,00	12,00	13,50	15,50	18,00	
Thread length / Diş uzunluğu	b ¹	44,00	48,00	52,00	56,00	60,00	66,00	72,00	78,00	
	b ²	Fully threaded. / Tam dişli.								

b¹ for lengths l ≤ 125 mm.

b² for lengths l 125 mm. ≤ 200 mm.

b³ for lengths > 200 mm.

Thread size / Anma çapı (d)			M16	M18	M20	M22	M24	M27	M30	M33
Length Boy	min.	max.	Weight /Ağırlık gr/p							
			5	4,76	5,24					
6	5,76	6,24								
8	7,71	8,29								
10	9,71	10,29								
12	11,65	12,35								
16	15,65	16,35								
20	19,58	20,42								
25	24,58	25,42	71,30							
30	29,58	30,42	77,80	111,00	128,00					
35	34,50	35,50	84,40	120,00	139,00	211,00				
40	39,50	40,50	91,00	129,00	150,00	224,00	270,00			
45	44,50	45,50	97,60	138,00	161,00	237,00	285,00	330,00	500,00	
50	49,50	50,50	106,00	147,00	172,00	250,00	300,00	352,00	527,00	630,00
55	54,40	55,60	114,00	156,00	183,00	263,00	316,00	374,00	554,00	665,00
60	69,40	60,60	122,00	165,00	194,00	276,00	330,00	396,00	581,00	700,00
65	64,40	65,60	130,00	174,00	205,00	291,00	345,00	418,00	608,00	735,00
70	69,40	70,60	130,00	183,00	216,00	306,00	363,00	440,00	635,00	770,00
80	79,40	80,60	154,00	203,00	241,00	336,00	399,00	484,00	690,00	830,00
90	89,30	90,70	170,00	223,00	266,00	366,00	435,00	529,00	745,00	900,00

DIN 912 HEXAGON SOCKET HEAD CAP SCREWS

ISO 4762

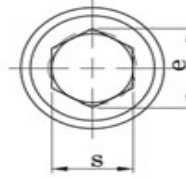
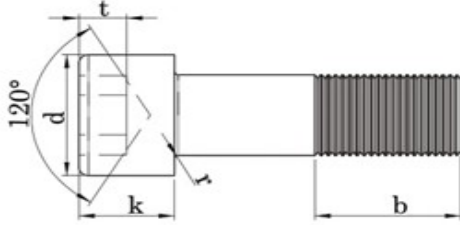

Teknik Bilgiler / Technical Informations		M16	M18	M20	M22	M24	M27	M30	M33	
Thread size / Anma çapı (d)		M16	M18	M20	M22	M24	M27	M30	M33	
Pitch / Diş adımı	P	2,00	2,50	2,50	2,50	3,00	3,00	3,50	3,50	
Head height / Kafa yüksekliği	k	max.	16,00	18,00	20,00	22,00	24,00	27,00	30,00	33,00
		min.	15,57	17,57	19,48	21,48	23,48	26,48	29,48	32,38
Head Dia / Kafa çapı	d	max.	24,00	27,00	30,00	33,00	36,00	40,00	45,00	50,00
		min.	23,67	26,67	29,67	32,61	35,61	39,61	44,61	49,61
Socket width / Soket genişliği	s	min.	14,00	14,00	17,00	17,00	19,00	19,00	22,00	24,00
		max.	14,03	14,03	17,05	17,05	19,07	19,07	22,07	24,07
Socket dia / Soket çapı	e	min.	14,03	14,03	17,05	17,05	19,07	19,07	22,07	24,07
		max.	14,21	14,21	17,23	17,23	19,28	19,28	22,28	24,28
Socket depth / Soket derinliği	t	8,00	9,00	10,00	11,00	12,00	13,50	15,50	18,00	
Thread length / Diş uzunluğu	b ¹	44,00	48,00	52,00	56,00	60,00	66,00	72,00	78,00	
	b ²	Fully threaded. / Tam dişli.								

b¹ for lengths l ≤ 125 mm.

b² for lengths l 125 mm. ≤ 200 mm.

b³ for lengths > 200 mm.

Thread size / Anma çapı (d)		M16	M18	M20	M22	M24	M27	M30	M33	
Length Boy	min.	Weight / Ağırlık gr/p								
	max.									
100	99,30	100,70	186,00	243,00	291,00	396,00	471,00	574,00	800,00	970,00
110	109,30	110,70	202,00	263,00	316,00	426,00	507,00	619,00	855,00	1040,00
120	119,30	120,70	218,00	283,00	341,00	456,00	543,00	664,00	910,00	1110,00
130	129,20	130,80	234,00	303,00	366,00	486,00	579,00	709,00	965,00	1180,00
140	139,20	140,80	250,00	323,00	391,00	516,00	615,00	754,00	1020,00	1250,00
150	149,20	150,80	266,00	343,00	416,00	546,00	651,00	799,00	1080,00	1320,00
160	159,20	160,80	282,00	363,00	441,00	576,00	687,00	844,00	1130,00	1390,00
180	179,20	180,80		403,00	491,00	636,00	759,00	934,00	1240,00	1530,00
200	199,10	200,90		443,00	541,00	696,00	831,00	1020,00	1350,00	1670,00
220	219,10	220,90			691,00	756,00	903,00	1110,00	1460,00	1810,00
240	239,10	240,90			741,00		975,00	1230,00	1570,00	1950,00
260	258,95	261,05						1340,00	1680,00	2040,00
280	278,95	281,05							1790,00	2180,00
300	298,95	301,05							1900,00	2320,00

COATING : Plain, Zinc Plate, Zinc Flake, HDG

HARDNESS: Grade 8.8 , Grade 10.9, Grade 12.9 available