



Wide range fasteners manufacturer.

ANCHOR BOLTS CATALOG



- ✓ Drop-in Anchor
- ✓ Sleeve in Anchor (T Type)
- ✓ Hook Type Anchor
- ✓ Eye Bolt Type Anchor
- ✓ S Type Anchor
- ✓ Wedge Anchor
- ✓ Plastic Wall Plug Series
- ✓ Plastic Dowel





DROP IN ANCHORS

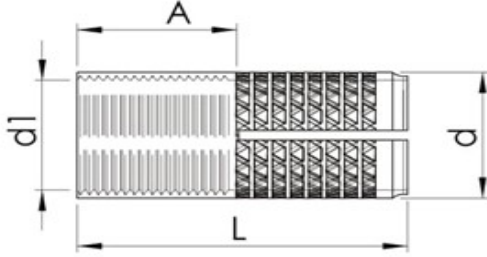

Teknik Bilgiler / Technical Informations						
ÖLÇÜ SIZE	DÜBEL & DELİK ÇAP ANCHOR & HOLE DIAMETERS	DÜBEL BOYU ANCHOR LENGTH	MAX. VİDALAMA BOYU MAX. SCREWING LENGTH	MAX. ÇEKME YÜKÜ MAX. TENSILE LOAD	MAX. SIKMA TORKU MAX. TIGHTENING TORQUE	AĞIRLIK WEIGHT
d1	d	L	A	kN	Nm	Gr
M6	8,00	25,00	10,00	1,00	5,00	6,60
M8	10,00	30,00	12,00	1,80	10,00	12,16
M10	12,00	40,00	15,00	3,70	20,00	22,93
M12	15,00	50,00	18,00	5,70	40,00	47,00
M14	18,00	55,00	20,00	6,60	60,00	64,28
M16	20,00	65,00	25,00	7,50	80,00	110,50
M20	25,00	80,00	35,00	11,50	150,00	189,50

Drop-In anchors are female concrete anchors designed for anchoring into concrete. Drop the anchor into the pre-drilled hole in the concrete. Using a setting tool expands the anchor within the hole in the concrete. Drop-in anchors require a setting tool to install.

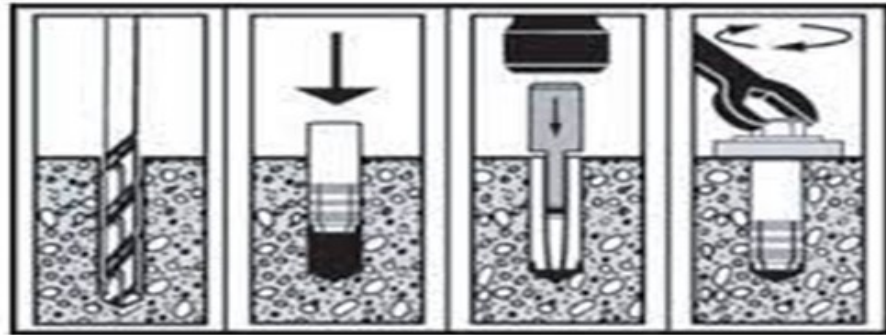



SLEEVE IN ANCHORS - T TYPE

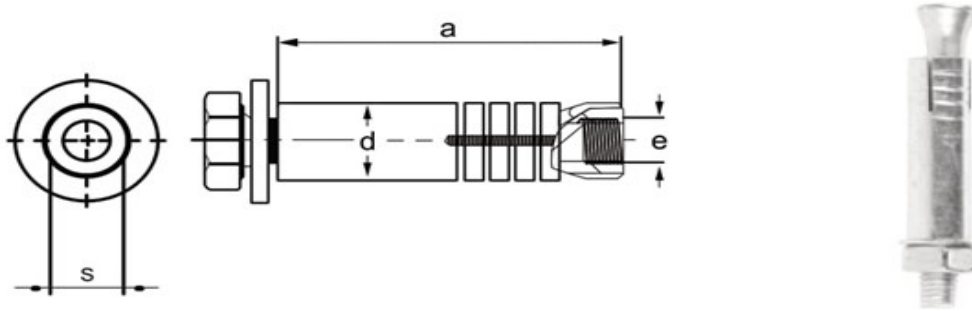

Teknik Bilgiler / Technical Informations								
DÜBEL KALINLIĞI ANCHOR THICKNESS	DÜBEL BOYU ANCHOR LENGTH	DÜBEL BORU ANCHOR HOLE	BORU KALINLIĞI PIPE THICKNESS	ANKRAJ BOYU ANCHORAGE LENGTH	BORU UZUNLUĞU PIPE LENGTH	MAX. SIKMA TORKU MAX. TIGHTENING	MAX. ÇAŞILMA YÜKÜ MAX. WORK LOAD	AĞIRLIK WEIGHT
d1	L	d	t	a	L1	Nm	kN	Gr
M 6	65,00	10,00	1,00	50,00	45,00	25,00	5,00	23,00
M 8	75,00	13,00	1,20	62,00	45,00	45,00	9,00	42,00
M 8	110,00	13,00	1,20	95,00	85,00	45,00	9,00	59,00
M 10	85,00	15,00	1,20	70,00	50,00	65,00	9,00	77,00
M 10	110,00	15,00	1,20	95,00	85,00	65,00	11,00	102,00
M 12	90,00	16,00	1,20	75,00	55,00	90,00	11,00	110,00
M 14	110,00	19,00	1,50	90,00	75,00	110,00	14,00	176,00
M 16	120,00	22,00	2,00	90,00	75,00	120,00	18,00	263,00

Sleeve anchors are quick, easy & versatile masonry anchoring systems, that expand against the base material when the bolt is tightened to allow for a stronger connection and to help distribute load bearing weight.

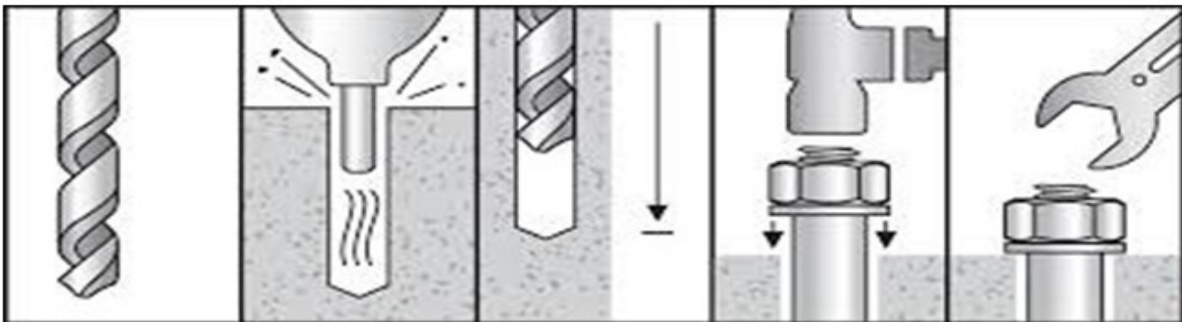



SLEEVE IN ANCHORS - F TYPE

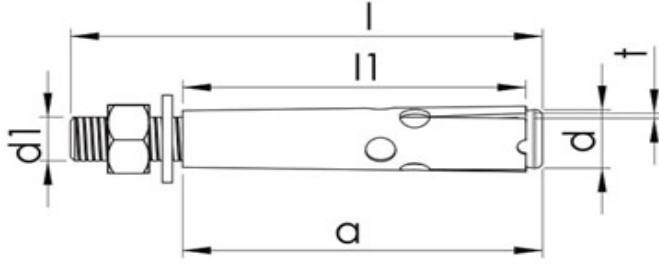

Teknik Bilgiler / Technical Informations								
DÜBEL KALINLIĞI ANCHOR THICKNESS	DÜBEL UZUNLUĞU ANCHOR LENGTH	DÜBEL& DELİK ÇAPI ANCHOR & HOLE DIAMETER	GÖMLEK BOYU SLEEVE LENGTH	ANKRAJ BOYU ANCHORAGE LENGTH	SAC KALINLIĞI SHEET IRON THICKNESS	EMNİYET ÇEKME YÜKÜ SAFE TENSILE LOAD	SIKMA TORKU TIGHTENING TORQUE	AĞIRLIK WEIGHT
d1	e	d	L1	a	t	Nm	kN	Gr
M 6	45,00	8,00	35,00	35,00	1,00	1,50	24,00	15,00
M 6	65,00	8,00	45,00	50,00	1,00	1,50	24,00	20,00
M 8	55,00	10,00	35,00	40,00	1,00	2,00	28,00	30,00
M 8	75,00	10,00	55,00	60,00	1,00	2,00	28,00	39,00
M 8	90,00	10,00	65,00	75,00	1,00	2,00	28,00	47,00
M 10	70,00	12,00	50,00	55,00	1,00	3,10	65,00	57,00
M 10	85,00	12,00	65,00	70,00	1,00	3,10	65,00	66,00
M 10	110,00	12,00	85,00	90,00	1,00	3,10	65,00	84,00
M 12	75,00	16,00	55,00	60,00	1,20	5,00	115,00	100,00
M 12	90,00	16,00	65,00	70,00	1,20	5,00	115,00	110,00
M 12	110,00	16,00	75,00	95,00	1,20	5,00	115,00	133,00





HOOK TYPE ANCHOR

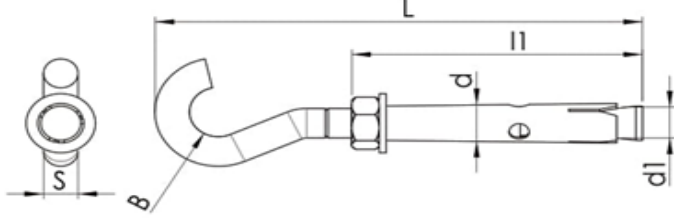

Teknik Bilgiler / Technical Informations						
ÖLÇÜ SIZE	KANCA BOYU HOOK LENGTH	DİŞ BOYU THREAD LENGTH	KONİK SOMUN ÇAPI CONIC NUT DIAMETER	GÖMLEK ÇAPI SLEEVE DIAMETER	KANCA İÇ ÇAPI INNER DIAMETER OF THE HOOK	AĞIRLIK WEIGHT
D	L	L1	S	d	B	Gr
M 6	92,00	60,00	8,00	8,00	14,00	30,00
M 8	105,00	70,00	10,00	10,00	14,00	56,00
M 10	120,00	70,00	12,00	12,00	16,00	93,00

Hooked anchor bolts are curved on the embedded end of the bolt, and the protrusion that this curvature creates acts as the load bearing member for the entire bolt.





EYE BOLT TYPE ANCHORS

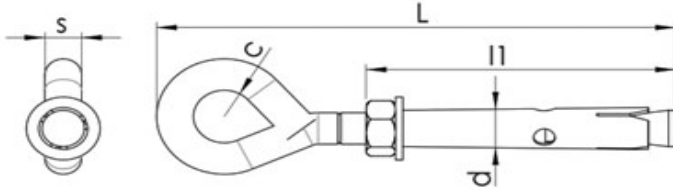

Teknik Bilgiler / Technical Informations						
ÖLÇÜ SIZE	KANCA BOYU HOOK LENGTH	DİŞ BOYU THREAD LENGTH	KONİK SOMUN ÇAPI CONIC NUT DIAMETER	GÖMLEK ÇAPI SLEEVE DIAMETER	KANCA İÇ ÇAPI INNER DIAMETER OF THE HOOK	AĞIRLIK WEIGHT
D	L	L1	S	d	C	Gr
M 6	92,00	60,00	8,00	8,00	14,00	32,00
M 8	105,00	70,00	10,00	10,00	14,00	60,00
M 10	120,00	70,00	12,00	12,00	16,00	98,00





S TYPE ANCHOR

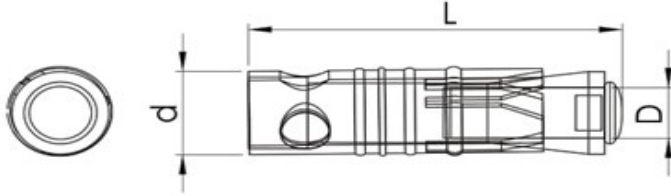

Teknik Bilgiler / Technical Informations						
ÖLÇÜ SIZE	GÖMLEK MATKAP DÜBEL DELİK ÇAPI SLEEVE ANCHOR HOLE DIAMETER	ANKRAJ DÜBEL BOYU ANCHORAGE ANCHOR LENGTH	DELİK BOYU HOLE LENGTH	SIKMA TORKU TIGHTENING TORQUE	EMNİYET ÇEKME YÜKÜ SAFE TENSILE LOAD	AĞIRLIK WEIGHT
D	d	L		Nm	kN	Gr
M 6	10,00	46,00	50,00	22,00	0,75	
M 8	12,00	50,00	60,00	60,00	3,50	16,00
M 10	15,00	55,00	70,00	78,00	5,00	27,00
M 12	18,00	80,00	85,00	115,00	7,50	44,50
M 16	24,00	90,00	95,00	150,00	8,50	





WEDGE IN ANCHOR

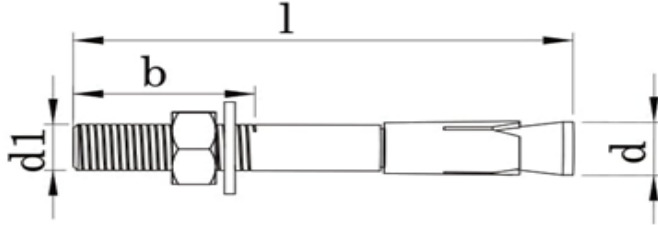

Teknik Bilgiler / Technical Informations					
DÜBEL KALINLIĞI ANCHOR THICKNESS	UZUNLUK LENGTH	MATKAP-DÜBEL DELİK DRILL-ANCHOR HOLE DIAMETER	DİŞ UZUNLUĞU THREAD LENGTH	MAX. SIKMA TORKU MAX. TIGHTENING TORQUE	EMNİYETLİ ÇEKME YÜKÜ SAFE TENSILE LOAD
d1	L	d	b	Nm	kN
M 6	65,00	6,00	30,00	21,00	1,10
M 6	75,00	6,00	30,00	21,00	1,10
M 8	75,00	8,00	35,00	48,00	1,40
M 8	115,00	8,00	40,00	48,00	1,40
M 10	90,00	10,00	40,00	90,00	2,50
M 10	110,00	10,00	40,00	90,00	2,50
M 10	125,00	10,00	40,00	90,00	2,50
M 12	110,00	12,00	45,00	100,00	3,25
M 12	125,00	12,00	45,00	100,00	3,25
M 12	160,00	12,00	45,00	100,00	3,25
M 12	180,00	12,00	45,00	100,00	3,25
M 12	200,00	12,00	50,00	100,00	3,25
M 16	145,00	16,00	55,00	125,00	5,80
M 16	175,00	16,00	60,00	125,00	5,80
M 16	200,00	16,00	60,00	125,00	5,80
M 16	225,00	16,00	60,00	125,00	5,80
M 20	150,00	20,00	65,00	200,00	6,50
M 20	200,00	20,00	65,00	200,00	6,50
M 24	160,00	24,00	70,00	240,00	6,50
M 24	200,00	24,00	70,00	240,00	6,50
M 24	250,00	24,00	70,00	240,00	6,50

Wedge anchors are designed to anchor objects into concrete. They are installed into a pre-drilled hole, then the wedge is expanded by tightening the nut to securely anchor into the concrete. They are not removable after the anchor is expanded.





PLASTIC DOWEL



Teknik Bilgiler / Technical Informations						
ANMA ÇAPI THREAD SIZE	6 MM.	7 MM.	8 MM.	10MM.	12MM.	14 MM.
Boy Lengt	28,60	32,00	34,00	44,15	48,00	72,00
Çap Dia	6,00	7,20	8,00	10,00	12,00	18,00
Malzeme Material	Elteks	Elteks	Elteks	Elteks	Elteks	Elteks
Paket Adedi Package	1000	1000	1000	1000	500	250
Çuval Adedi Sack	50.000	25.000	25.000	25.000	10.000	5.000

The dowel is a sheath in which the screw rotates. It is a plastic part used especially for multi-hole, easily dispersible walls and for mounting heavy materials to the wall. There are threads inside the dowel for the screw to move easily. On the outside, there are thorn-like hooks that prevent the dowel from being pulled out.

**ADDRESS :**

Fevzi Çakmak Mah. 10768. Sk.
Zıp Code: 42050
Karatay / Konya / TÜRKİYE

+90 332 345 0427

+90 536 566 6990



www.bitorkfasteners.com



info@bitorkfasteners.com



PLASTIC WALL PLUG SERIES



8 mm (Şapkalı)				
EN	BOY	PAKET ADEDİ	ÇUVAL MİK.	HAM MADDE
8 mm	34 mm	500	25.000	Elteks
Performance Dübel Serisi 8 mm				
EN	BOY	PAKET ADEDİ	ÇUVAL MİK.	HAM MADDE
8 mm	50.30 mm	500	12.500	Random Copolimer
Performance Dübel Serisi 10 mm				
EN	BOY	PAKET ADEDİ	ÇUVAL MİK.	HAM MADDE
10 mm	60 mm	500	12.500	Random Copolimer
Tuğla Boşluk Dübeli 8 mm				
EN	BOY	PAKET ADEDİ	ÇUVAL MİK.	HAM MADDE
8 mm	49 mm	500	25.000	Copolimer
Tuğla Boşluk Dübeli 10 mm				
EN	BOY	PAKET ADEDİ	ÇUVAL MİK.	HAM MADDE
10 mm	58.30 mm	500	12.500	Copolimer
Tuğla Boşluk Dübeli 12 mm				
EN	BOY	PAKET ADEDİ	ÇUVAL MİK.	HAM MADDE
12 mm	-	250	12.500	Copolimer
Gaz Beton Dübeli 8 mm				
EN	BOY	PAKET ADEDİ	ÇUVAL MİK.	HAM MADDE
-	-	100	2.500	Elteks
Gaz Beton Dübeli 10 mm				
EN	BOY	PAKET ADEDİ	ÇUVAL MİK.	HAM MADDE
-	-	100	2.500	Elteks
Alçıpan Dübeli 2				
EN	BOY	PAKET ADEDİ	ÇUVAL MİK.	HAM MADDE
9 mm	28.5 mm	500	15.000	Elteks
Alçıpan Dübeli 3				
EN	BOY	PAKET ADEDİ	ÇUVAL MİK.	HAM MADDE
9 mm	33.5 mm	500	15.000	Elteks
Turbolet Dübeli Kısa				
EN	BOY	PAKET ADEDİ	ÇUVAL MİK.	HAM MADDE
-	-	500	25.000	Derlin





PLASTIC WALL PLUG SERIES



Turbolet Dübeli Kısa				
EN	BOY	PAKET ADEDİ	ÇUVAL MİK.	HAM MADDE
-	-	250	12.500	Derlin
Copolimer Siding Dübeli 8x100				
EN	BOY	PAKET ADEDİ	ÇUVAL MİK.	HAM MADDE
8 mm	100 mm	250	2.500	Copolimer
Copolimer Siding Dübeli 10x80				
EN	BOY	PAKET ADEDİ	ÇUVAL MİK.	HAM MADDE
10 mm	80 mm	100	5.000	Copolimer
Copolimer Siding Dübeli 10x100				
EN	BOY	PAKET ADEDİ	ÇUVAL MİK.	HAM MADDE
10 mm	100 mm	100	5.000	Copolimer
Oluklu Derz Artısı 3-4-5				
EN	BOY	PAKET ADEDİ	ÇUVAL MİK.	HAM MADDE
3 mm	30 mm	500	25.000	Elteks
4 mm	34 mm	500	25.000	Elteks
5 mm	38 mm	500	25.000	Elteks
Düz Derz Artısı 2-3-4-5				
EN	BOY	PAKET ADEDİ	ÇUVAL MİK.	HAM MADDE
2 mm	21 mm	1.000	50.000	Elteks
3 mm	24 mm	1.000	50.000	Elteks
4 mm	27 mm	1.000	50.000	Elteks
5 mm	32 mm	1.000	50.000	Elteks





HAMMER DRIVE ANCHOR

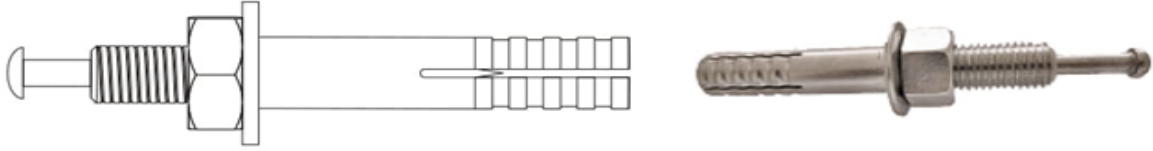

Teknik Bilgiler / Technical Informations		
BÜYÜKLÜK / SIZE	AĞIRLIK / WIEGHT	VURMA SAYISI / HAMMER DOWN
M6, 1/4	0.45	3 - 5
M8, 5/16	0.45	4 - 6
M10, 3/8	0.90	5 - 7
M12, 1/2	0.90	6 - 8
M16, 5/8	1.36	9 - 14
M20, 3/4	1.36	13 - 18

Hammer drive anchors are used for light duty fastening. They are best suited for installation in dry, indoor environments. They are not the best choice for use in damp or outdoor conditions. They should also not be used for overhead installation projects.

Hammer drive anchors can be used in lots of base materials, including concrete, brick, and concrete block.



Attention: They are permanent, so double check what you're about to fasten. Once the anchor is set in place, the item being attached cannot be removed without being destroyed.

